

## LAFARGE GTEC AQUA BOARD INTERNAL APPLICATION INSTALLATION GUIDE (MEDIUM & RATHER HIGH)

### 1. Application

The table below shows the different internal applications where Lafarge GTEC Aqua Board can be used, including our recommendations.

Exposure to Humidity and Water	Framing	Board	Fixings	Jointing	Special Requirements
<b>MEDIUM</b>					
<b>HOUSING - Kitchens &amp; Toilets</b>	Standard Lafarge GTEC Frame	Lafarge GTEC Moisture Board	Standard Lafarge GTEC Screws	Standard Lafarge GTEC Jointing	Seal the base of the Lafarge GTEC Moisture Board with a proprietary silicone sealant
	Standard Lafarge GTEC Frame	Lafarge GTEC Aqua Board	Standard Lafarge GTEC Screws	Lafarge GTEC Aquamix	Seal the base of the Lafarge GTEC Aqua Board with a proprietary silicone sealant
<b>RATHER HIGH</b>					
<b>HOUSING - Bathrooms, Garages, Unheated Cellar</b>	Standard Lafarge GTEC Frame	Lafarge GTEC Moisture Board	Standard Lafarge GTEC Screws	Standard Lafarge GTEC Jointing	Apply a coat of Lafarge GTEC Drywall Sealer over the entire surface of the GTEC Moisture Board and seal the base of the GTEC Moisture Board with a proprietary silicone sealant.
	Standard Lafarge GTEC Frame	Lafarge GTEC Aqua Board	Standard Lafarge GTEC Screws	Lafarge GTEC Aquamix	Seal the base of the Lafarge GTEC Aqua Board with a proprietary silicone sealant
<b>HIGH</b>					
<b>HOUSING - Individual Shower, Bathroom with a Jacuzzi</b>	<b>See Lafarge GTEC Aqua Board Internal Installation Guide for High &amp; Severe Wet Areas</b>				
<b>PUBLIC BUILDINGS - Private Bathroom with a Jacuzzi, Shower for Collective Use, Collective Changing Rooms, Collective Laundry etc</b>	<b>See Lafarge GTEC Aqua Board Internal Installation Guide for High &amp; Severe Wet Areas</b>				
<b>SEVERE</b>					
<b>HOUSING - Internal Private Swimming Pool</b>	<b>See Lafarge GTEC Aqua Board Internal Installation Guide for High &amp; Severe Wet Areas</b>				
<b>PUBLIC BUILDINGS - Collective Showers, Collective Laundries with High Pressure Cleaning, Swimming Pools, Health Spas etc</b>	<b>See Lafarge GTEC Aqua Board Internal Installation Guide for High &amp; Severe Wet Areas</b>				

## LAFARGE GTEC AQUA BOARD INTERNAL APPLICATION INSTALLATION GUIDE (MEDIUM & RATHER HIGH)

### 1.1 Typical Partition Systems Utilising Lafarge GTEC Aqua Board:

#### GTEC Aqua Board Systems

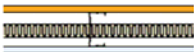
System Ref.	Plan Detail	Facing Side 1	Studs	Facing Side 2	Fire resistance (mins)	Sound Insulation (R <sub>w</sub> dB)	Max height (m)
REP003Aq		12.5mm GTEC Aqua Board	CS50/RX & 25mm glass mineral wool	12.5mm GTEC E Board or 12.5mm GTEC Aqua Board	30	40	2.4
REP042Aq		12.5mm GTEC Aqua Board	CS70/RX & 25mm glass mineral wool	12.5mm GTEC E Board or 12.5mm GTEC Aqua Board	30	43	3.6

The above systems have a **BS5234** duty grade of **MEDIUM**.

## 2. Installation Procedure

### 2.1 Lafarge GTEC Studs & Tracks

Fix the Lafarge GTEC Tracks, along the setting out line, at the floor and soffit. Fix to the floor and soffit at maximum 600 mm centres, with suitable proprietary fixings. If applying the Lafarge GTEC U Tracks direct to new concrete, which has not completely dried out, a damp proofing membrane should be used. Cut the Lafarge GTEC C Studs 5 mm shorter than the floor to soffit height, allowing for floor variations. Insert the Lafarge GTEC C Studs into the Lafarge GTEC U Tracks and twist into position. The perimeter Lafarge GTEC C Studs should be fixed at maximum 600 mm centres, with the webs flat against the abutting wall or column, with suitable proprietary fixings.

If a deflection tolerance is required at the head of the partition, the Lafarge GTEC C Studs should be cut short by this deflection tolerance and the appropriate Lafarge U Track used (see the Lafarge Drywall Manual).

The intermediate Lafarge GTEC C Studs should all face in the same direction and should be positioned at maximum 600 mm centres (or reduced stud centres if required). For single layer partitions, which are to be finished with tiling, the intermediate Lafarge GTEC C Studs should be positioned at a maximum of 400mm centres (see the Lafarge Drywall manual).

### 2.2 Lafarge GTEC Aqua Board

Fix the Lafarge GTEC Aqua Board to the wet area side of the Lafarge GTEC Framing. Cut the Lafarge GTEC Aqua Board 5 mm to 8 mm shorter than the floor-to-ceiling height, butt firmly against the ceiling and fix with Lafarge GTEC Aqua Screws to the framing at a maximum of 300 mm centres in the field of the board and at a maximum of 300 mm at the partition perimeter. Offset the Lafarge GTEC boarding type on the opposite side by one stud spacing (600 mm or 400 mm).

To maximise the acoustic and fire performance of the system, use Lafarge GTEC Intumescent Acoustic Sealant and seal between the perimeters and Lafarge GTEC Aqua Board at the vertical abutments and the head. The base should be sealed with a proprietary silicone based sealant. Alternatively, a continuous 6 mm bead of Lafarge GTEC Intumescent Acoustic Sealant can be applied to the back of the Lafarge GTEC U Tracks and the perimeter Lafarge GTEC C Studs and the base should be sealed with a proprietary silicone based sealant.

## LAFARGE GTEC AQUA BOARD INTERNAL APPLICATION INSTALLATION GUIDE (MEDIUM & RATHER HIGH)

### 2.3 Joint Treatment to Surface of GTEC Aqua Board

Apply Lafarge GTEC Aquamix compound to the tapered joint. Cut the Lafarge GTEC Joint Tape to the required length, centre the Lafarge GTEC Joint Tape over the Lafarge GTEC Aqua Board joint and bed tape into the Lafarge Aquamix compound. Apply Lafarge GTEC Aquamix compound to the Lafarge GTEC Aqua Board joint, covering the Lafarge GTEC Joint Tape with approximately 1 mm of Lafarge GTEC Aquamix compound. Strike off flush with the Lafarge GTEC Aqua Board face and allow drying. Once fully dry, apply a second coat of Lafarge GTEC Aquamix compound over the first coat and feather out 50 – 60 mm wider than the first coat of Lafarge GTEC Aquamix compound and allow drying. Once fully dry, apply a finish coat of Lafarge GTEC Aquamix over the second coat and feather out 50 – 60 mm wider than the second coat of Lafarge GTEC Aquamix.

### 2.4 Treatment of External Vertical Corners (where a non tiled finish has been specified)

Cut the Lafarge GTEC Corner 90° External (tape on bead) to the required length. Apply a 50 mm wide band of Lafarge GTEC Aquamix compound on each side of the external corner. Bed the Lafarge GTEC Corner 90° External into the Lafarge GTEC Aquamix compound. Once bedded, cover each side of the Lafarge GTEC Corner 90° External with a 100mm band of Lafarge GTEC Aquamix, feathered out onto the Lafarge GTEC Aqua Board face, and allow drying. Once fully dry, apply a second coat of Lafarge GTEC Aquamix compound over the first coat and feather out 50 – 60 mm wider than the first coat of Lafarge GTEC Aquamix compound and allow drying. Once fully dry, apply a finish coat of Lafarge GTEC Aquamix over the second coat and feather out 50 – 60 mm wider than the second coat of Lafarge GTEC Aquamix.

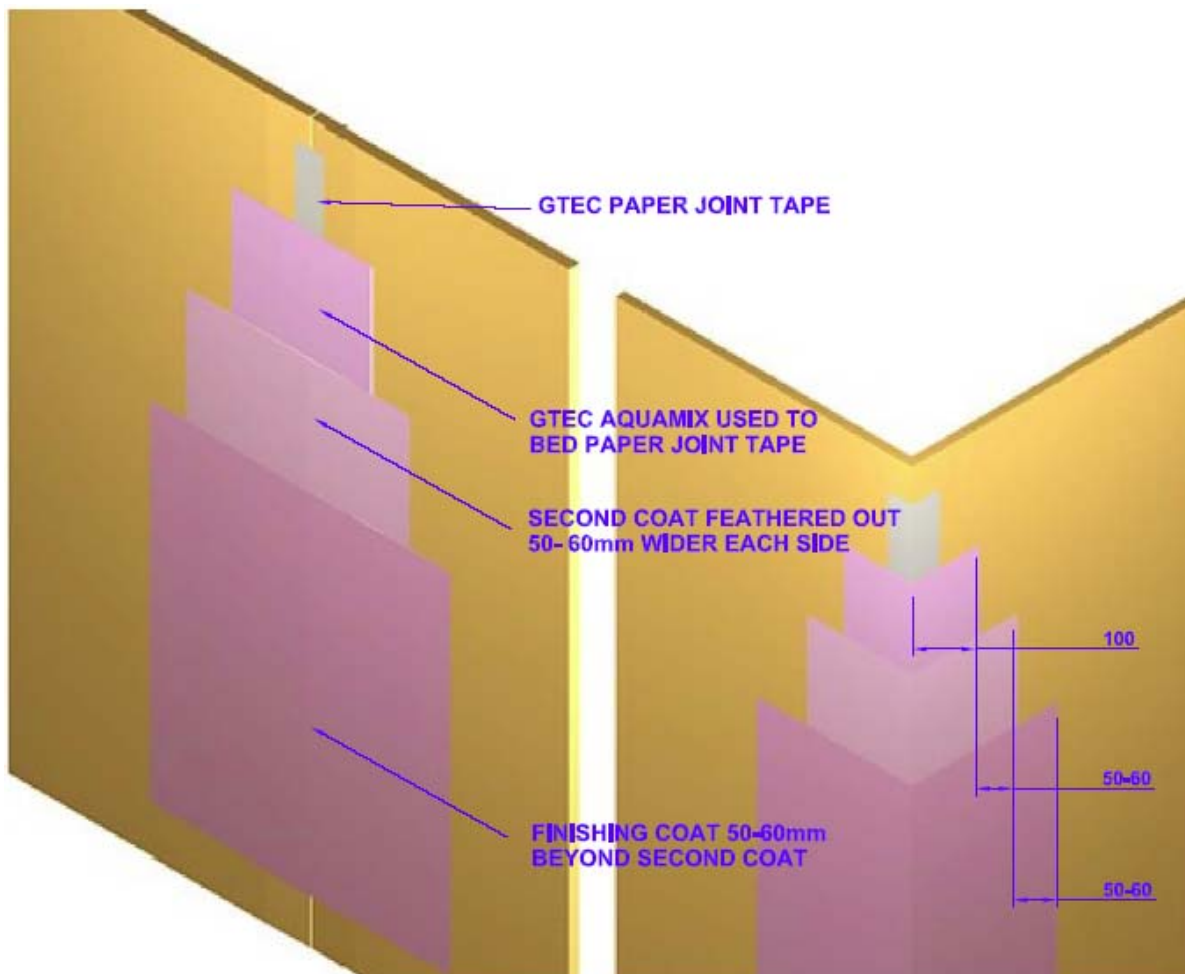

**LAFARGE GTEC AQUA BOARD  
INTERNAL APPLICATION INSTALLATION GUIDE  
(MEDIUM & RATHER HIGH)**

### 3. Lafarge GTEC Aqua Board Finishing

#### 3.1 Tiling Finish

Ceramic & glazed tiles can be fixed directly onto the Lafarge GTEC Aqua board system. The tile adhesive should be waterproof and suitable for plasterboard substrates.

Tiles with less than 5% water absorption are recommended.

##### 3.11 Grouting

After the tile adhesive has been allowed to set, according to the adhesive manufacturer's recommendations, finish the tiles with a suitable waterproof tile grout and seal tiles if required.

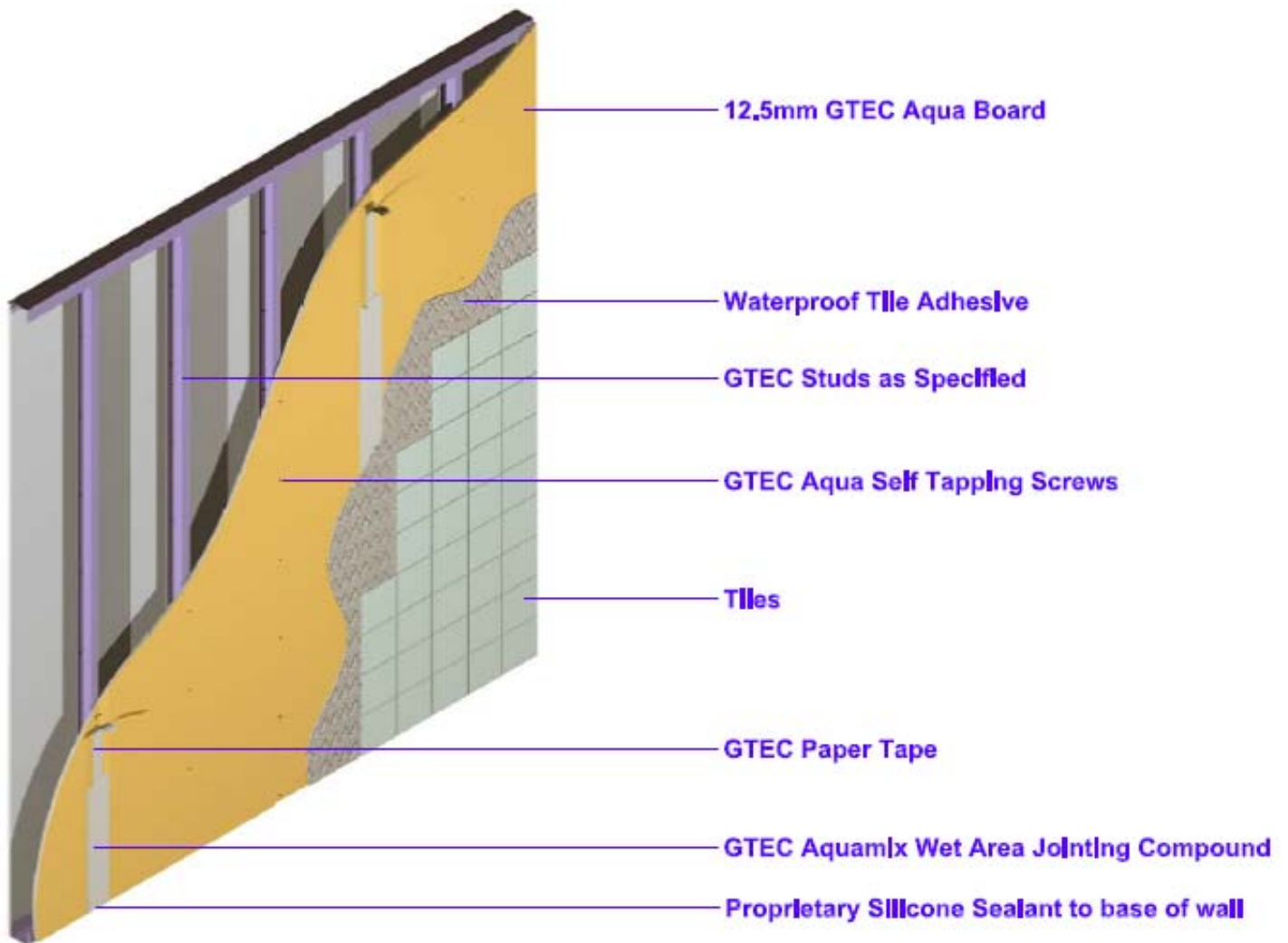

## LAFARGE GTEC AQUA BOARD INTERNAL APPLICATION INSTALLATION GUIDE (MEDIUM & RATHER HIGH)

### 3.2 Paint Finish

For non-tiled areas, where a paint finish is required, a suitable proprietary paint for that area can be applied directly to the Lafarge GTEC Aqua Board surface.

The following paints have been tested to ensure their compatibility with Lafarge GTEC Aqua Board. It is, however, necessary to refer to the manufacturer's technical sheet to ensure that the paint is compatible for the use for which it is intended and to check the recommendations for use.

#### 3.2.1 Zolpan System

- Maoline primer, mixed aqueous acrylic/alkyd sealer: ready-to-use white product in compliance with the French Environment Standard. Application: 1 coat with a roller or spray gun (8 to 10 m<sup>2</sup> /l), drying time 30 minutes, second coat applied after 2 hours; clean brushes with water.
- Ultramur A finish, epoxy paint in the aqueous phase: a pre-dosed, bi-component product, in compliance with the Excell environment standards, withstands repeated washing and suited to the highest health and safety standards. Application: 2 coats with a roller or spray gun (10 to 12 m<sup>2</sup> /l), drying time 2 hours, second coat applied after 12 hours; clean brushes with water.

### 3.3 Additional Detailing

#### Water tightness around frames

To ensure water tightness around door frames and/or any apertures, a proprietary silicone based sealant should be used.

#### Pipes passing through Partition

Pipes should be sleeved and a proprietary silicone based sealant should be used to ensure water tightness between the sleeve and pipe. Water tightness is also achieved between the Lafarge GTEC Aqua Board, tiling and sleeve, using a proprietary silicone based sealant.

#### Suspended washroom appliances

Suspended washroom appliances may be fixed to partitions using a suitable fixing and method (see the Lafarge Drywall Manual). A proprietary silicone based sealant may be required around any penetrations.

#### Baths and Showers

A proprietary silicone based sealant must be used at the junction of the shower base and/or the bath edges to the vertical walls. Follow the bath and/or shower manufacturer's recommendations for fixing requirements.